

PISTON CHECK VALVES—Class 150#, 300#, 600#

Size range: 2" to 10"

Class 150# Fig NO.7150—PL(RF/RTJ)
7150 1/2—PL(BW)

DIMENSIONS AND WEIGHTS

Size inch	d	A RF & BW	B	Weight(kg) RF & BW	
2"	51	203	131	14	11
3"	76	241	163	28	21
4"	102	292	188	45	38
6"	152	406	235	81	69
8"	203	495	277	136	111
10"	254	622	337	244	195

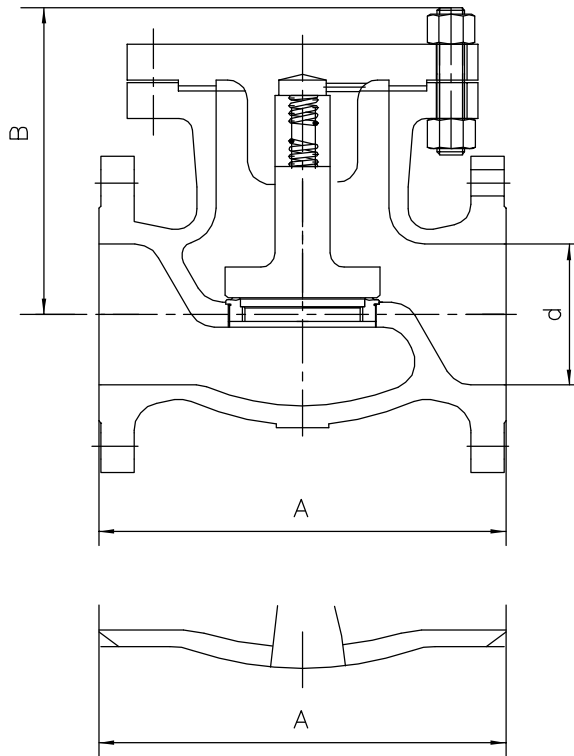

Class 300# Fig NO.7300—PL(RF/RTJ)
7300 1/2—PL(BW)

DIMENSIONS AND WEIGHTS

Size inch	d	A RF & BW	B	Weight(kg) RF & BW	
2"	51	267	142	24	19
3"	76	318	175	47	35
4"	102	356	217	76	65
6"	152	445	252	133	116
8"	203	559	305	255	216
10"	254	622	352	361	298

Class 600# Fig NO.7600—PL(RF/RTJ)
7600 1/2—PL(BW)

DIMENSIONS AND WEIGHTS

Size inch	d	A RF & BW	B	Weight(kg) RF & BW	
2"	51	292	166	33	29
3"	76	356	185	58	51
4"	102	432	240	104	95
6"	152	559	345	254	209
8"	200	660	425	405	335
10"	248	787	480	635	578

STANDARDS:

Design	ANSI B16.34&BS 1868
Test	API 598
Face to Face Dimensions	ANSI B16.10
End Flange Dimensions	ANSI B16.5
Butt-Weld Ends	ANSI B16.25

Other Sizes:On request

RF:Flanged BW:Butt Weld

AVAILABLE OPTIONS:

STRUCTURE	End,Connection: Flange Raised Face,Butt Weld,RTJ...
	Seat Rings: Threaded(Renewable),Welded
* MATERIALS	Body: WCB,WC1,WC6,WC9,LCB,LCC,LC3,C5,C12,CF8,CF8M,CF3,CF3M,CF8C...
	Trims: 13%Cr,304,304L,316,316L,321,347,F-51,Monel...

*Please refer to page of "Build Material"