

GATE VALVES—Class 1500#

Size range: 2" to 24"

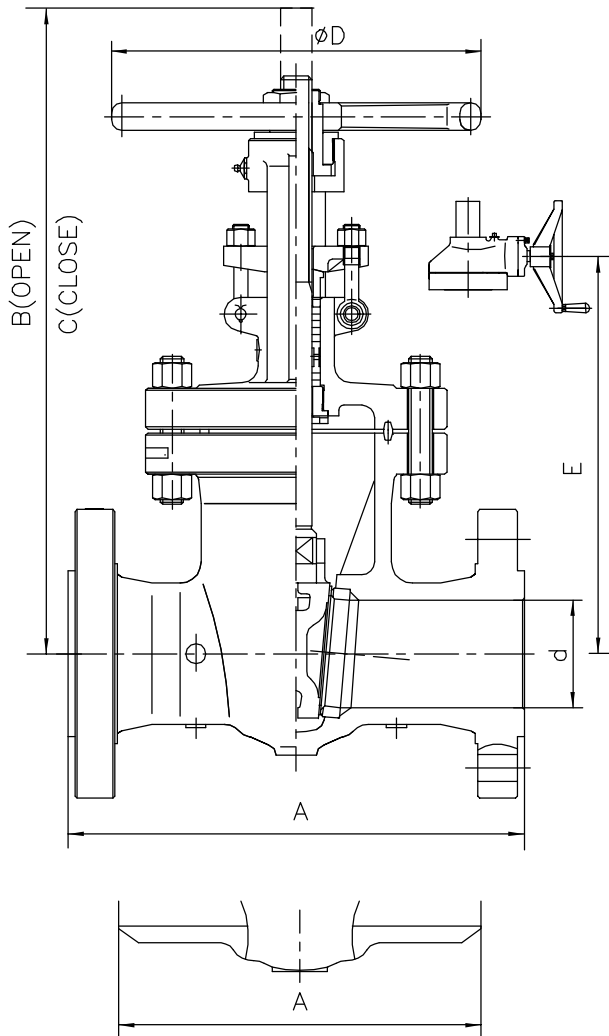

STANDARDS:	
Design	ANSI B16.34&API 600
Test	API 598
Face to Face Dimensions	ANSI B16.10
End Flange Dimensions	ANSI B16.5
Butt-Weld Ends	ANSI B16.25

Class 1500# Fig NO. 97(RF/RTJ)
97 1/2 (BW)

DIMENSIONS AND WEIGHTS

Size inch	d	A RF & BW	B (OPEN)	C (CLOSE)	D	E	Weight(kg) RF & BW	
2"	47	368	494	432	254		117	93
3"	70	470	564	658	380		240	185
4"	92	546	715	787	510		337	285
6"	136	705	945	1186	610	1273	680	584
8"	178	832	1227	1267	800	1354	1228	978
10"	222	991	1426	1558	900	1658	2278	1990
12"	263	1130	1633	1738	900	1838	3260	2850
14"	289	1257	1777	1907	1100	2050	4100	3320
16"	330	1384	2061	2195	1300	2338	5960	4890
18"	371	1537	2322	2492	1500	2685	6375	6240
20"	415	1664	3100	2620	1500	2815	6875	6540
24"	498	1941	3720	3170	1500	3105	10300	9240

Other Sizes and materials: On request

RF: Flanged BW: Butt Weld

Sizes 6" and larger the use of gear actuator is recommended.

AVAILABLE OPTIONS:

STRUCTURE	End Connection: Flange Raised Face, Butt Weld, RTJ...
	Seat Rings: Threaded (Renewable), Welded
	Operation: Handwheel, Gear, Electric, Pneumatic, Hydraulic...
* MATERIALS	Body: WCB, WC1, WC6, WC9, LCB, LCC, LC3, C5, C12, CF8, CF8M, CF3, CF3M, CF8C...
	Trims: 13%Cr, 304, 304L, 316, 316L, 321, 347, F-51, Monel...
ACCESSORIES	Limited switch, Sealing water connection, Bypass, Drain, Equalizing pipes and Etc.

* Please refer to page of "Build Material"